



Quick - connects

SQC Series, SFQC Series



www.SuperlokUSA.com

5777 Olivas Park Dr Unit#G
Ventura, CA 93003

805-658-2043

sales@superlokusa.com

FULL FLOW QUICK - CONNECTS

SFQC SERIES



FEATURES

- Proven ball - lock mechanism provides positive connection.
- Simple push - pull action to connect and disconnect lines - no tools required.
- Compact coupling offers full flow without orifice restrictions.
- O-ring is easily replaced without disassembling body.

TABLE OF DIMENSIONS

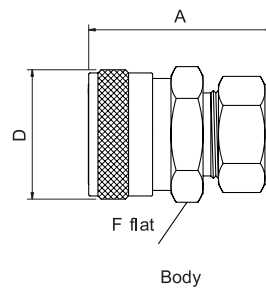
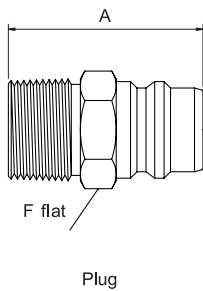

Unit : mm

Unit : mm

Ordering Number		End Connection		Cv	Min Orifice	A	F		
Body Series	Part no.	Type							
SFQC2-PG	S 4	1/4 " Superlok		2.2	4.8	45.0	14.3		
	S 6	3/8 " Superlok		2.8			17.5		
	M 4N(R)	1/4 " Male NPT		1.7	6.1	40.4	14.3		
	M 6N(R)	3/8 " Male NPT(PT)					17.5		
	M 4G	1/4 " Male PF				40.6	19.1		
	F 4N(R)	1/4 " Female NPT(PT)				42.4	22.2	40.6	19.1
	F 6N(R)	3/8 " Female NPT(PT)							
	F 4G	1/4 " Female PF							
F 6G	3/8 " Female PF								
SFQC3-PG	S 6	3/8 " Superlok				2.9	7.1	47.8	22.2
	S 8	1/2 " Superlok		13.0	10.4	50.5			
	M 6N(R)	3/8 " Male NPT(PT)		7.1	10.4	41.9			
	M 8N(R)	1/2 " Male NPT(PT)		11.5	12.7	46.7			
	M 8G	1/2 " Male PF		11.5	12.7	46.2	27.0		
	F 6N(R)	3/8 " Female NPT(PT)		7.1	11.9	40.4			
	F 8N(R)	1/2 " Female NPT(PT)		11.5	12.7	46.2			
	F 8G	1/2 " Female PF							
SFQC4-PG	S 12	3/4 " Superlok		26.0	15.7	54.6	27.0		
	M 12N(R)	3/4 " Male NPT(PT)		23.6	18.3	51.6			
	F 12N(R)	3/4 " Female NPT(PT)				52.8		33.3	
SFQC5-PG	S 16	1 " Superlok				45.0		62.2	34.9
	M 16N(R)	1 " Male NPT(PT)		39.0	22.4	59.7			
	F 16N(R)	1 " Female NPT(PT)				63.2	41.3		

Ordering Number		End Connection		Min Orifice	A	D	F	
Body Series	Part no.	Type						
SFQC2-BY	S 4	1/4 " Superlok		4.8	45.7	22.2	17.5	
	S 6	3/8 " Superlok		7.1	46.0			
	M 4N(R)	1/4 " Male NPT		6.4	40.0			
	M 6N(R)	3/8 " Male NPT(PT)		9.4	40.0			
	M 4G	1/4 " Male PF		6.1	45.7		38.1	19.1
	F 4N(R)	1/4 " Female NPT(PT)		9.7	41.4			22.2
	F 6N(R)	3/8 " Female NPT(PT)						
	F 4G	1/4 " Female PF						
F 6G	3/8 " Female PF							
SFQC3-BY	S 6	3/8 " Superlok		7.1	55.1	33.0	27.0	
	S 8	1/2 " Superlok		11.9	56.6			
	M 6N(R)	3/8 " Male NPT(PT)		10.4	46.5			
	M 8N(R)	1/2 " Male NPT(PT)		12.7	52.8			
	M 8G	1/2 " Male PF		11.9	52.8		43.9	38.1
	F 6N(R)	3/8 " Female NPT(PT)		15.0	43.9			
	F 8N(R)	1/2 " Female NPT(PT)		16.0	43.9			
	F 8G	1/2 " Female PF						
SFQC4-BY	S 12	3/4 " Superlok		15.7	62.2	42.6	38.1	
	M 12N(R)	3/4 " Male NPT(PT)		18.3	59.2			
	F 12N(R)	3/4 " Female NPT(PT)		22.4	48.0			
SFQC5-BY	S 16	1 " Superlok		22.4	70.0	49.0	44.5	
	M 16N(R)	1 " Male NPT(PT)		26.9	53.8			
	F 16N(R)	1 " Female NPT(PT)						

Dimensions are for reference only and are subject to change.

FULL FLOW QUICK - CONNECTS

SFQC SERIES

MATERIALS OF CONSTRUCTION

Component	Material	
	316 SS	Brass
Body	316 SS	Brass
Sleeve		
Locking ball		
Spring		
Sanp ring		
O - ring	Viton	NBR
Plug	316 SS	Brass

PRESSURE-TEMPERATURE RATINGS

Temperature °F (°C)	316 SS with Viton O - ring				Brass with NBR O - ring			
	SFQC 2	SFQC 3	SFQC 4	SFQC 5	SFQC 2	SFQC 3	SFQC 4	SFQC 5
Pressure Rating, coupled, psig (bar)								
70 (20)	6000 (413)		4000 (275)		4000 (275)	3000 (206)		2000 (137)
250 (121)					100 (6.8)			
400 (204)	100 (6.8)							

INSERTION DEPTH

Series	Depth, in (mm)
SFQC2	0.78 (19.8)
SFQC3	0.81 (20.6)
SFQC4	0.90 (23.0)
SFQC5	0.94 (23.9)

OPTION

BODY & PLUG PROTECTOR

Body & Plug Protectors guard against damage and contaminants when bodies and plug are uncoupled.

Series	Ordering Number	
	Body Protector	Plug Protector
SFQC 2	SFQC2 - BP	SFQC2 - PP
SFQC 3	SFQC3 - BP	SFQC3 - PP
SFQC 4	SFQC4 - BP	SFQC4 - PP
SFQC 5	SFQC5 - BP	SFQC5 - PP

ORDERING INFORMATION

SQC4 - BY - M - 12N - SS

1
2
3
4

- 1 Body Series**
- SFQC2 - BY
 - SFQC3 - BY
 - SFQC4 - BY
 - SFQC5 - BY
- Plug Series**
- SFQC2 - PG
 - SFQC3 - PG
 - SFQC4 - PG
 - SFQC5 - PG

- 2 End Connection**
- S : SUPERLOK Tube Fitting
 - F : Female Thread
 - M : Male Thread

- 3 End Connection Size**
- Tube O.D Designation

Tube O.D (inch)	1/4	3/8	1/2	3/4	1
Designation	4	6	8	12	4
Tube O.D (mm)	6	10	12	20	25
Designation	6M	10M	12M	20M	25M

- Pipe Thread Designation

Size (inch)	1/4	3/8	1/2	3/4	1
Screwed BSPT	4R	6R	8R	12R	16R
Screwed NPT	4N	6N	8N	12N	16N
Screwed BSPP	4G	6G	8G	12G	16G

- 4 Body Material**
- SS : 316 Stainless Steel
 - B : Brass